

SEAT DETAIL

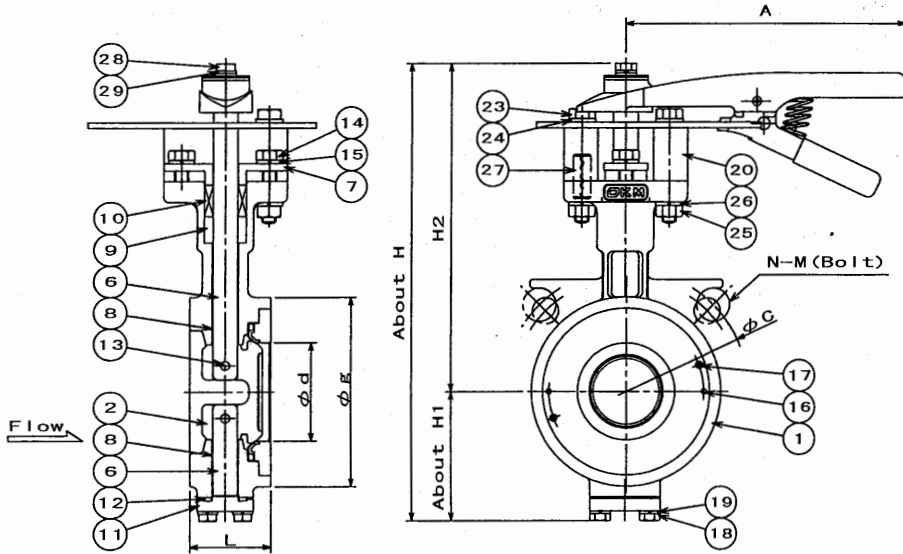
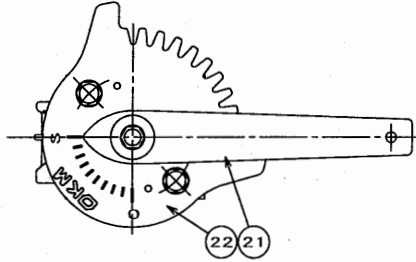

No.	PARTS NAME	Check	MATERIAL	Check	MATERIAL	Check	MATERIAL	Q'ty	REMARK
					SEMI STANDARD		SEMI STANDARD		
1	BODY		SCS13A		SCS14A		SCS16A	1	
2	DISC		SCS13A (PLATED)		SCS14A (PLATED)		SCS16A (PLATED)	1	
3	SET RING		SCS13A		SCS14A		SCS16A	1	
4	SEAT RING		SUS316 (PLATED)		SUS316 (PLATED)		SUS316L (PLATED)	1	
5	SEAT GASKET		NON-ASBESTOS		NON-ASBESTOS		NON-ASBESTOS	2	
6	STEM		SUS304		SUS316		SUS316L	1set	
7	GLAND		SCS14A		SCS14A		SCS14A	1	
8	BUSH		SUS316+PTFE		SUS316+PTFE		SUS316+PTFE	1set	
9	PACKING WASHER		SUS304		SUS316		SUS316L	1	
10	GLAND PACKING		PTFE		PTFE		PTFE	1set	
11	COVER		SCS13A		SCS14A		SCS16A	1	
12	GASKET		NON-ASBESTOS		NON-ASBESTOS		NON-ASBESTOS	1	
13	TAPER PIN		SUS304		SUS316		SUS316L	1set	
14	GLAND BOLT		SUS304		SUS316		SUS316	2	
15	SPRING WASHER		SUS304		SUS316		SUS316	2	
16	SET PIN		SUS420J2		SUS420J2		SUS420J2	2	
17	DRAW OUT SCREW		SUS304		SUS316		SUS316	2	
18	COVER BOLT		SCM435 (PLATED)		SCM435 (PLATED)		SCM435 (PLATED)	4	
19	SPRING WASHER		SUS304		SUS316		SUS316	4	
20	SPACER YOKE		SCS13A		SCS13A		SCS13A	2	
21	LEVER		FCMB		FCMB		FCMB	1	
22	INDICATOR		SS400 (PLATED)		SS400 (PLATED)		SS400 (PLATED)	1	
23	BOLT		SUS304		SUS304		SUS304	2	
24	WASHER		SUS304		SUS304		SUS304	2	
25	NUT		SUS304		SUS304		SUS304	2	
26	SPRING WASHER		SUS304		SUS304		SUS304	2	
27	SPRING PIN		SUS420J2		SUS420J2		SUS420J2	2	
28	BOLT		SUS304		SUS304		SUS304	1	
29	SPRING WASHER		SUS304		SUS304		SUS304	1	

Check	SIZE	d	L	g	H	H1	H2	A	LEVER SIZE	WEIGHT (About)
	50mm	42.5	43	92	242	64	178	160	160L	3.7Kg
	65mm	56	46	108	262	74	188	160	160L	4.2Kg

SIZE	JIS5K			JIS10K		
	C	N	M	C	N	M
50mm	105	4	M12	120	4	M16
65mm	130	4	M12	140	4	M16

日付 DATE	Nov. 14. 2007	尺度 SCALE	FREE	製造番号 MFG. No.	
最高使用圧力 MAX. WORKING PRESS.	1.0 MPa Pa	使用温度 WORKING TEMP.	-29~232 °C	形式 TYPE	MODEL 541M (K)
耐圧試験 SHELL TEST	1.5 MPa Pa	試験流体 TEST FLUID	WATER	名称 NAME	BUTTERFLY VALVES WITH LEVER OPERATOR
弁座試験 SEAT TEST	1.1 MPa Pa	許容漏れ LEAKAGE	MSS SP-61		
作成 DRAWN	検討 CHECKED	承認 APPROVED			
	K O I	7.11	<i>[Signature]</i>		
株式会社オーケーエム OKUMURA ENGINEERING corp.			図面番号 DRAWING No.	541M LA 0195 E	Hd-lan975 SYONINST

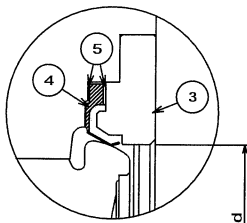

SEAT DETAIL

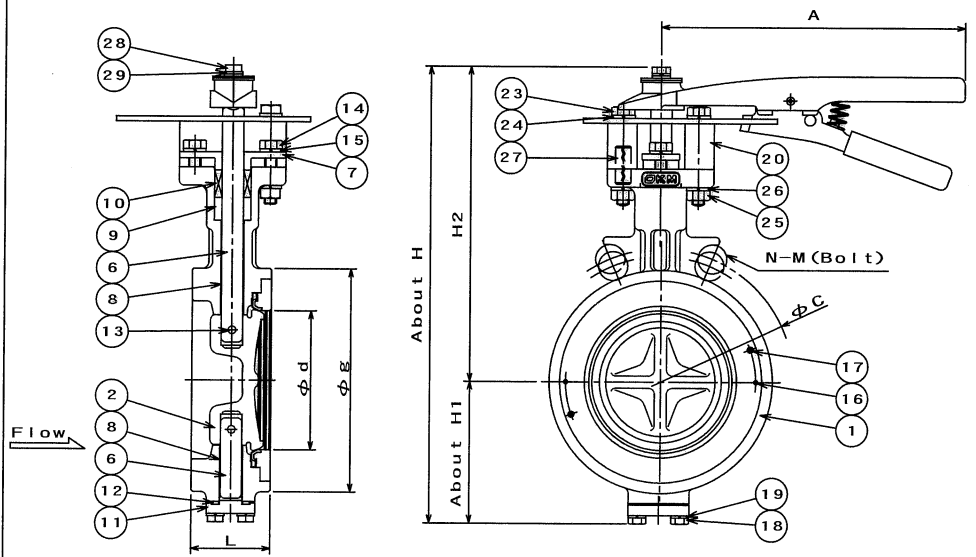
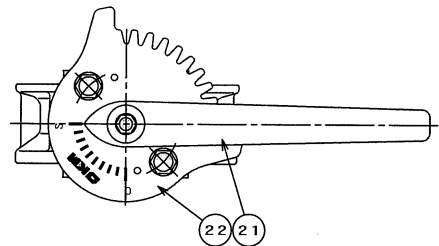

No.	PARTS NAME	Check	MATERIAL	Check	MATERIAL	Check	MATERIAL	Q'ty	REMARK
			STANDARD		SEMI STANDARD		SEMI STANDARD		
1	BODY		SCS13A		SCS14A		SCS16A	1	
2	DISC		SCS13A (PLATED)		SCS14A (PLATED)		SCS16A (PLATED)	1	
3	SET RING		SCS13A		SCS14A		SCS16A	1	
4	SEAT RING		SUS316 (PLATED)		SUS316 (PLATED)		SUS316L (PLATED)	1	
5	SEAT GASKET		NON-ASBESTOS		NON-ASBESTOS		NON-ASBESTOS	2	
6	STEM		SUS304		SUS316		SUS316L	1set	
7	GLAND		SCS14A		SCS14A		SCS14A	1	
8	BUSH		SUS316+PTFE		SUS316+PTFE		SUS316+PTFE	1set	
9	PACKING WASHER		SUS304		SUS316		SUS316L	1	
10	GLAND PACKING		PTFE		PTFE		PTFE	1set	
11	COVER		SCS13A		SCS14A		SCS16A	1	
12	GASKET		NON-ASBESTOS		NON-ASBESTOS		NON-ASBESTOS	1	
13	TAPER PIN		SUS304		SUS316		SUS316L	1set	
14	GLAND BOLT		SUS304		SUS316		SUS316	2	
15	SPRING WASHER		SUS304		SUS316		SUS316	2	
16	SET PIN		SUS420J2		SUS420J2		SUS420J2	2	
17	DRAW OUT SCREW		SUS304		SUS316		SUS316	2	
18	COVER BOLT		SCM435 (PLATED)		SCM435 (PLATED)		SCM435 (PLATED)	4	
19	SPRING WASHER		SUS304		SUS316		SUS316	4	
20	SPACER YOKE		SCS13A		SCS13A		SCS13A	2	
21	LEVER		FCMB		FCMB		FCMB	1	
22	INDICATOR		SS400 (PLATED)		SS400 (PLATED)		SS400 (PLATED)	1	
23	BOLT		SUS304		SUS304		SUS304	2	
24	WASHER		SUS304		SUS304		SUS304	2	
25	NUT		SUS304		SUS304		SUS304	2	
26	SPRING WASHER		SUS304		SUS304		SUS304	2	
27	SPRING PIN		SUS420J2		SUS420J2		SUS420J2	2	
28	BOLT		SUS304		SUS304		SUS304	1	
29	SPRING WASHER		SUS304		SUS304		SUS304	1	

Check	SIZE	d	L	g	H	H1	H2	A	LEVER SIZE	MASS (About)
	80mm	70.0	46	127	283	84	199	200	200L	4.9kg
	100mm	91.5	52	147	303	94	209	200	200L	5.7kg
	125mm	119.0	56	180	359	110	248	360	360L	10.5kg
	150mm	143.5	56	209	388	124	263	360	360L	11.8kg

SIZE	JIS5K			JIS10K		
	C	N	M	C	N	M
80mm	145	4	M16	150	8	M16
100mm	165	8	M16	175	8	M16
125mm	200	8	M16	210	8	M20
150mm	230	8	M16	240	8	M20

日付 DATE	Nov. 14. 2007	尺度 SCALE	FREE	製造番号 MFG. No.	
最高使用圧力 MAX. WORKING PRESS.	1.0 MPa P _g	使用温度 WORKING TEMP.	-29~232 °C	形式 TYPE	MODEL 541M (K)
耐圧試験 SHELL TEST	1.5 MPa P _g	試験流体 TEST FLUID	WATER	名称 NAME	BUTTERFLY VALVES WITH LEVER OPERATOR
弁座試験 SEAT TEST	1.1 MPa P _g	許容漏れ LEAKAGE	MSS SP-61		
作成 DRAWN	検討 CHECKED	承認 APPROVED		株式会社オーケーエム OKUMURA ENGINEERING corp.	
				図面番号 DRAWING No.	541M LA 0196 EA
					Hd-1an975 SYONINST

△OCT. 9, 2012