

BULKHEAD FEMALE CONNECTOR (SBW Type)

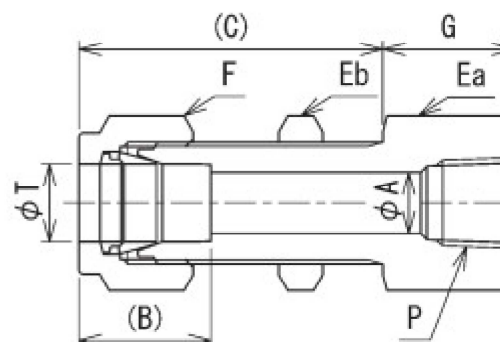
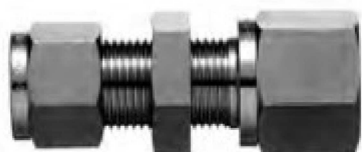

UNIT : mm

型番	チューブ 外径	管用テーパ めねじ	最小穴径	差込深さ	組込長さ	六角対辺				パネル取付 穴径	最大取付幅
TYPE NO.	TUBE O.D.	PIPE THREAD	MIN. BORE	DEPTH	APPROX	WIDTH ACROSS HEX				PANEL HOLE DRILL	MAX. PANEL MOUNT THICKNESS
	T	P	A	B	C	Ea	Eb	F	G		

[ミリサイズチューブ用]

SBW- 3M- 2RC	3	RC1/8	2.4	13	31.2	14	14	12	14	8.3	10.3
SBW- 3M- 4RC	3	RC1/4	2.4	13	31.2	19	14	12	18	8.3	10.3
SBW- 4M- 2RC	4	RC1/8	3	13.7	32	14	14	12	14.2	9.9	11
SBW- 4M- 4RC	4	RC1/4	3	13.7	32	19	14	12	18.2	9.9	11
SBW- 6M- 2RC	6	RC1/8	4.5	15.6	34.6	15.8	15.8	14	14	11.5	10.5
SBW- 6M- 4RC	6	RC1/4	4.5	15.6	34.6	19	15.8	14	18	11.5	10.5
SBW- 6M- 6RC	6	RC3/8	4.5	15.6	34.6	22	15.8	14	20	11.5	10.5
SBW- 6M- 8RC	6	RC1/2	4.5	15.6	34.6	27	15.8	14	25	11.5	10.5
SBW- 8M- 2RC	8	RC1/8	6	16.4	36.7	17.4	17.4	15.8	14	13	11.5
SBW- 8M- 4RC	8	RC1/4	6	16.4	36.7	19	17.4	15.8	18	13	11.5
SBW- 8M- 6RC	8	RC3/8	6	16.4	36.7	22	17.4	15.8	20	13	11.5
SBW- 8M- 8RC	8	RC1/2	6	16.4	36.7	27	17.4	15.8	25	13	11.5
SBW-10M- 4RC	10	RC1/4	8	17.2	37.7	22	22	19	18	16.3	11.5
SBW-10M- 6RC	10	RC3/8	8	17.2	37.7	22	22	19	20	16.3	11.5
SBW-10M- 8RC	10	RC1/2	8	17.2	37.7	27	22	19	25	16.3	11.5
SBW-12M- 4RC	12	RC1/4	10	23.1	41.4	24	24	22	18	19.5	12.5
SBW-12M- 6RC	12	RC3/8	10	23.1	41.4	24	24	22	20	19.5	12.5
SBW-12M- 8RC	12	RC1/2	10	23.1	41.4	27	24	22	25	19.5	12.5