

# MALE CONNECTOR (SHW Type)

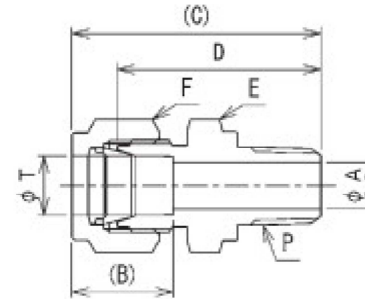

UNIT : mm

型番	チューブ外径	管用テーパ おねじ	最小穴径	差込深さ	組込長さ	本体長さ	六角対辺	
TYPE NO.	TUBE O.D.	PIPE THREAD	MIN. BORE	DEPTH	APPROX	BODY	WIDTH ACROSS HEX	
	T	P	A	B	C	D	E	F

[インチサイズチューブ用] チューブ外径の ( ) 内はインチ表示

SHW- 1C- 1R	1.58(1/16")	R1/16	1.4	8.3	24.3	20.5	8	8
SHW- 1C- 2R	1.58(1/16")	R1/8	1.4	8.3	25.8	22	12	8
SHW- 1C- 4R	1.58(1/16")	R1/4	1.4	8.3	29.8	26	14	8
SHW- 2C- 1R	3.17(1/8")	R1/16	2.4	13	30.2	23.5	10	12
SHW- 2C- 2R	3.17(1/8")	R1/8	2.4	13	30.2	23.5	12	12
SHW- 2C- 4R	3.17(1/8")	R1/4	2.4	13	35.2	28.5	14	12
SHW- 3C- 2R	4.76(3/16")	R1/8	3.2	13.7	31.2	24.5	12	14
SHW- 3C- 4R	4.76(3/16")	R1/4	3.2	13.7	36.2	29.5	14	14
SHW- 4C- 2R	6.35(1/4")	R1/8	4.8	15.6	36.6	29	14	14
SHW- 4C- 4R	6.35(1/4")	R1/4	4.8	15.6	39.1	31.5	14	14
SHW- 4C- 6R	6.35(1/4")	R3/8	4.8	15.6	40.1	32.5	17.4	14
SHW- 4C- 8R	6.35(1/4")	R1/2	4.8	15.6	44.6	37	22	14
SHW- 6C- 2R	9.52(3/8")	R1/8	5	17.2	39.2	31.5	17.4	17.4
SHW- 6C- 4R	9.52(3/8")	R1/4	7.5	17.2	41.7	34	17.4	17.4
SHW- 6C- 6R	9.52(3/8")	R3/8	7.5	17.2	42.2	34.5	17.4	17.4
SHW- 6C- 8R	9.52(3/8")	R1/2	7.5	17.2	46.7	39	22	17.4
SHW- 8C- 2R	12.7(1/2")	R1/8	5	23.1	41.9	31.5	22	22
SHW- 8C- 4R	12.7(1/2")	R1/4	7.5	23.1	44.4	34	22	22
SHW- 8C- 6R	12.7(1/2")	R3/8	10.4	23.1	44.9	34.5	22	22
SHW- 8C- 8R	12.7(1/2")	R1/2	10.4	23.1	49.4	39	22	22
SHW-10C- 6R	15.88(5/8")	R3/8	10	24.9	45	34.4	24	27
SHW-10C- 8R	15.88(5/8")	R1/2	12	24.9	50.1	39.5	24	27
SHW-10C-12R	15.88(5/8")	R3/4	13	24.9	51.1	40.5	27	27
SHW-12C- 8R	19.05(3/4")	R1/2	12	24.9	51.1	40.5	27	30
SHW-12C-12R	19.05(3/4")	R3/4	16	24.9	51.1	40.5	27	30
SHW-12C-16R	19.05(3/4")	R1	16	24.9	58.4	47.8	35	30
SHW-14C- 8R	22.23(7/8")	R1/2	12	26.6	51.6	41	30	32
SHW-14C-12R	22.23(7/8")	R3/4	16	26.6	51.6	41	30	32
SHW-16C-12R	25.4(1")	R3/4	16	31.7	57.9	45.2	35	38
SHW-16C-16R	25.4(1")	R1	22.3	31.7	62.7	50.0	35	38