

## FEMALE CONNECTOR (SPW Type)

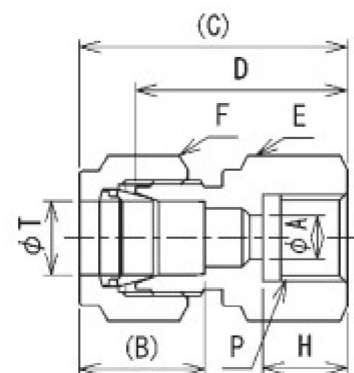

UNIT : mm

型 番	チューブ外径	管用平行 ネジ	最小穴径	差込深さ	組込長さ	本体長さ	六角対辺		ねじ深さ
TYPE NO.	TUBE O.D.	PIPE THREAD	MIN. BORE	DEPTH	APPROX	BODY	WIDTH ACROSS HEX		DEPTH
	T	P	A	B	C	D	E	F	H

### [ミリサイズチューブ用]

SPW- 6M- 2GC	6	G1/8	3	15.6	32.1	24.5	15.8	14	9
SPW- 6M- 4GC	6	G1/4	4.5	15.6	36.1	28.5	19	14	14
SPW- 6M- 6GC	6	G3/8	4.5	15.6	38.1	30.5	22	14	16
SPW- 6M- 8GC	6	G1/2	4.5	15.6	43.1	35.5	27	14	17.5
SPW- 8M- 2GC	8	G1/8	3	16.4	32.7	25	15.8	15.8	9
SPW- 8M- 4GC	8	G1/4	5.5	16.4	36.7	29	19	15.8	14
SPW- 8M- 6GC	8	G3/8	5.5	16.4	38.7	31	22	15.8	16
SPW- 8M- 8GC	8	G1/2	5.5	16.4	43.7	36	27	15.8	17.5
SPW-10M- 2GC	10	G1/8	3	17.2	33.7	26	19	19	9
SPW-10M- 4GC	10	G1/4	5.5	17.2	37.7	30	19	19	14
SPW-10M- 6GC	10	G3/8	5.5	17.2	39.7	32	22	19	16
SPW-10M- 8GC	10	G1/2	5.5	17.2	44.7	37	27	19	17.5
SPW-12M- 2GC	12	G1/8	3	23.1	37.4	27	22	22	9
SPW-12M- 4GC	12	G1/4	5.5	23.1	40.4	30	22	22	14
SPW-12M- 6GC	12	G3/8	5.5	23.1	42.4	32	22	22	16
SPW-12M- 8GC	12	G1/2	5.5	23.1	47.4	37	27	22	17.5